



SEA BOX®

Relocatable Simulation Shelter (RSS) - Size 12S

Sea Box's Relocatable Simulation Shelter (RSS) provides a durable, reliable and efficient shelter to support simulator operations.

Ease of Setup

The shelter frames have a Patented collapsible design which simplifies set up. The end frames of the shelters remain attached to the floor and roof panels of the shelter during transport. When the ceiling is lifted during deployment, the end frames slide into place creating a solid structure. Panels are then positioned in channels around the perimeter and are bolted in place from the interior of the shelter for quick assembly.

Fully Redeployable

The key feature of our RSS is its ease of disassembly, pack out and transport for redeployment. Sea Box's RSS can be disassembled and loaded on flatbed trailers for domestic transport or into 40' high cube ISO containers for overseas shipment.

Base Model Key Features

- Shelter can be set-up and ready for use in three weeks on an approved concrete pad
- Walls and ceiling panels consist of a galvanized steel exterior and perforated steel interior with a core made of non-combustible structural mineral wool for superior insulation and noise absorption.
- Wall panel design is water resistant and durable for relocation, pack up and shipping.
- Insulation R value of 21.
- Shelter comes equipped with two 7.5-10 ton PLC controlled ECUs
- Plug and Play electric. LED interior and exterior lighting.
- Electrical system includes wiring for power monitors, phase sequencing, utility power, and Emergency Power-Off (EPO) switches.
- Main power 200A, 3-phase panel, 50/60Hz.
- Dedicated simulator power 200A, 3-phase.
- Fire, smoke, and heat detection system in accordance with NFPA regulations.
- Communications Interface Panel
- Conforms to Security Standards in DoDM 5200.01-V3 (Open Storage)
- Wind load rating 200 mph. Snow load rating 80 psf.
- Anti-static carpet tile, rubber tile or polyurea floor coating throughout

Contact Sea Box today for additional information or to discuss customized features for your shelter needs!

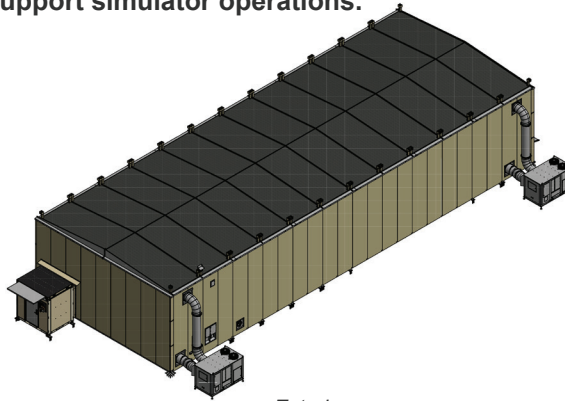

Exterior
33446 Desert Tan

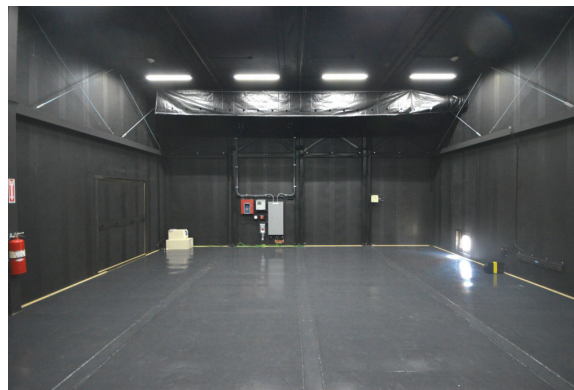

Interior
Flat Black



SB3897.RSS.8S shown

U.S. Patent No.
9,108,758

	LENGTH		HEIGHT			WIDTH		Volume
	Exterior	Interior	Exterior w/ Roof Lights	Exterior	Interior	Exterior	Interior	
Ft in	34' 1"	33' 1"	19' 7"	18' 7-3/4"	16'	91' 11-7/16"	90' 11-7/16"	48,144.52 Cu. Ft.
Metric	10,391	10,083	5,968	5,682	4,876	28,027	22,722	1,363.30 Cu. M.

* RSS width can be extended indefinitely in increments of 91" (2,311mm)

SB3897.RSS.12S
Relocatable Simulation Shelter (RSS) - Size 12S

051022-R00

ISO 9001



CERTIFIED QUALITY
MANAGEMENT SYSTEM